

12000 mAh Portable Battery Charger Quick Start Guide

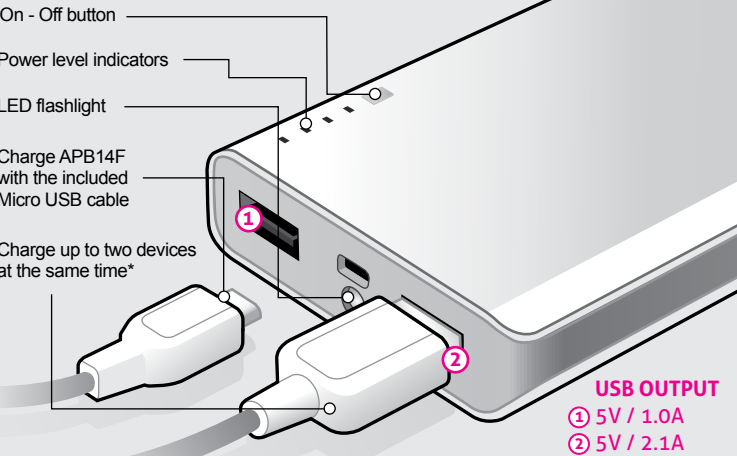

APB14F

Product Highlights



Operation

LED flashlight

To turn the LED flashlight on or off, simply press the power button twice.

Charging the battery pack

The battery is not fully charged and it is highly recommended that you charge APB14F before you begin using it.

Note: Using APB14F "out of the box" will not harm the device. You will experience reduced battery life as the unit will not be fully charged.

To charge the device, connect the larger end of the USB cable provided to your PC or a USB power adapter (not provided) and the Micro USB end to APB14F. Once it is fully charged, all 4 Blue LEDs will be on.

Tech Support & Warranty Information

Checking the capacity

The power status LEDs will light up according to available power capacity.



Charging your digital device

Use the original cable that came with your device or a cable with suitable connector. Connect the USB tip to one of the USB Output ports on the battery pack. Charging will start automatically once the cable is connected.

Radio and TV Interference Statement

If you need further assistance, please contact the Aluratek support department for troubleshooting prior to returning this device.

E-mail: support@aluratek.com
Web: www.aluratek.com/support
Local (Irvine, CA): 714-586-8730
Toll free: 1-866-580-1978

Aluratek warrants this product against defect in material or workmanship for **1 Year** from the date of purchase.

For more information, please visit: <http://aluratek.com/warranty-return-policy>

You can register your product online at: <http://aluratek.com/product-registration>

WARNING!!! This equipment has been tested and found to comply with the limits of a Class B digital device, pursuant to part 15 of the FCC rules. These limits are designed to provide reasonable protection against harmful interference in a residential installation.

This equipment generates, uses and can radiate radio frequency energy and, if not installed and used in accordance with the instruction, may cause harmful interference to radio communications. However, there is no guarantee that interference will not occur in a particular installation. If this equipment does cause harmful interference to radio or television reception, which can be determined by turning the equipment off and on, the user is encouraged to try to correct the interference by whatever measures may be required to correct the interference.